

TOURATECH

TOURING RALLYE RACING TECHNOLOGY

Januar 2004

09-040-1360-1

Installation Instruction Windshield Spoiler KTM LC8

Contains:

1 x Spoiler für Windschild

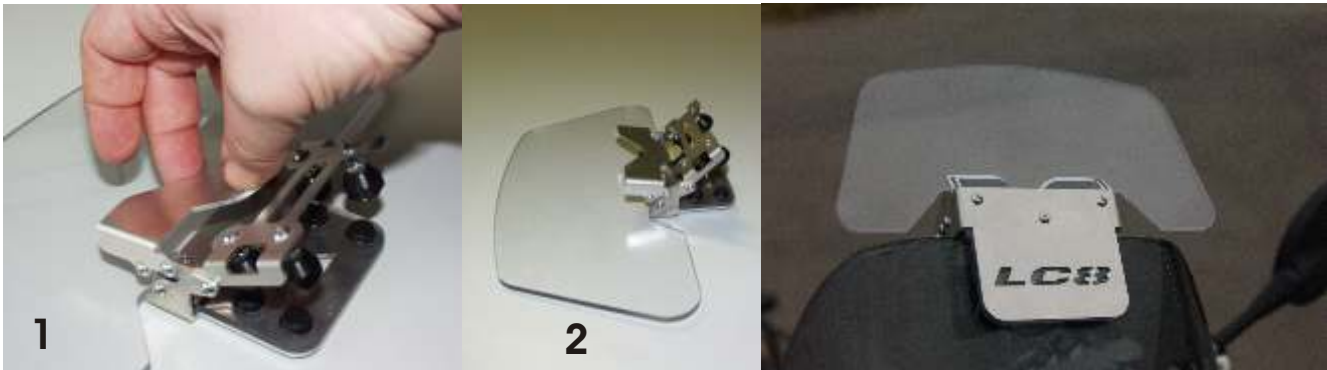

Installation:

Open the locking mechanism (Photo 1) and loosen the lock nuts on the four adjustment screws. Set the spoiler carefully on the windshield making sure not to damage any edge protector on the windshield edge.

Generally the spoiler is adjusted close to the stock windshield thickness so that it sits tightly when locking mechanism is clamped closed.

If adjustment is required, close the locking mechanism and set the adjusting nuts the strength of the windshield. The adjusting nuts should be set against the windshield relatively tightly. Tighten the lock nuts when spoiler sits tightly on the windshield. Open and close the spoiler to make sure it sits tightly on the windshield.

Make sure the spoiler sits tight before each ride and adjust if necessary.

Spoiler can be easily removed and set on the windshield. Make sure to readjust if used on other bikes, especially if the thickness of the windshield varies.

Attention !

Do not use gasoline or solvents for cleaning. Use water and soft cloth to avoid scratches.

ATTENTION !

THIS PART DOES NOT HAVE GERMAN TUV APPROVAL FOR STREET USE IN GERMANY !